



SoftPak-260 Soft-Box Assembly Machine
Datasheet

SoftPak-260[©]

Bronway's SoftPak-260 has been designed to address the growing demand for mid to high-end automated DVD SoftBox Packaging solutions in the most cost effective manner possible. This all-mechanical design offers significant advantages over existing systems:

- **Compact, small footprint**
- **Low cost**
- **Compatible with most soft-box style boxes**
- **Up to 60 cycles per minute**
- **Easy to use with quick job changeover**
- **Easy to maintain**



The SoftPak-260 is capable of handling a wide variety of Soft-Box types for DVD discs at rates of up to 60 per minute depending on box and component quality. The machine includes a title sheet insertion module and up to 3 booklets can be assembled in to each box. The current configuration of the machine allows for 1 disc to be inserted into the box. An optional ident code reader can be installed at the disc loading station. Any discs that fail ident code checking are placed on to a reject spindle and are not loaded in to the box. This is a safeguard against mixed product being accidentally or otherwise sent to the customer. At the exit station of the machine the user can select that the boxes are either closed automatically or left open for the manual insertion of additional components down-stream.

A key advantage of the SoftPak-260 is its innovative user-friendly design. Operators require minimal training; non-technical personnel can operate the SoftPak-260 with the set-up and product changeover being accomplished in minutes. Typically one operator is capable of running the entire machine and this may be a more flexible, cost-effective alternative to 2 operators running 1 high-speed machine. The innovative design reduces the need for regular planned maintenance. The use of standard, off-the-shelf components means that most electro-mechanical technicians can service the machine.

Machine Layout

SoftPak-260 Main Elements (Single disc):

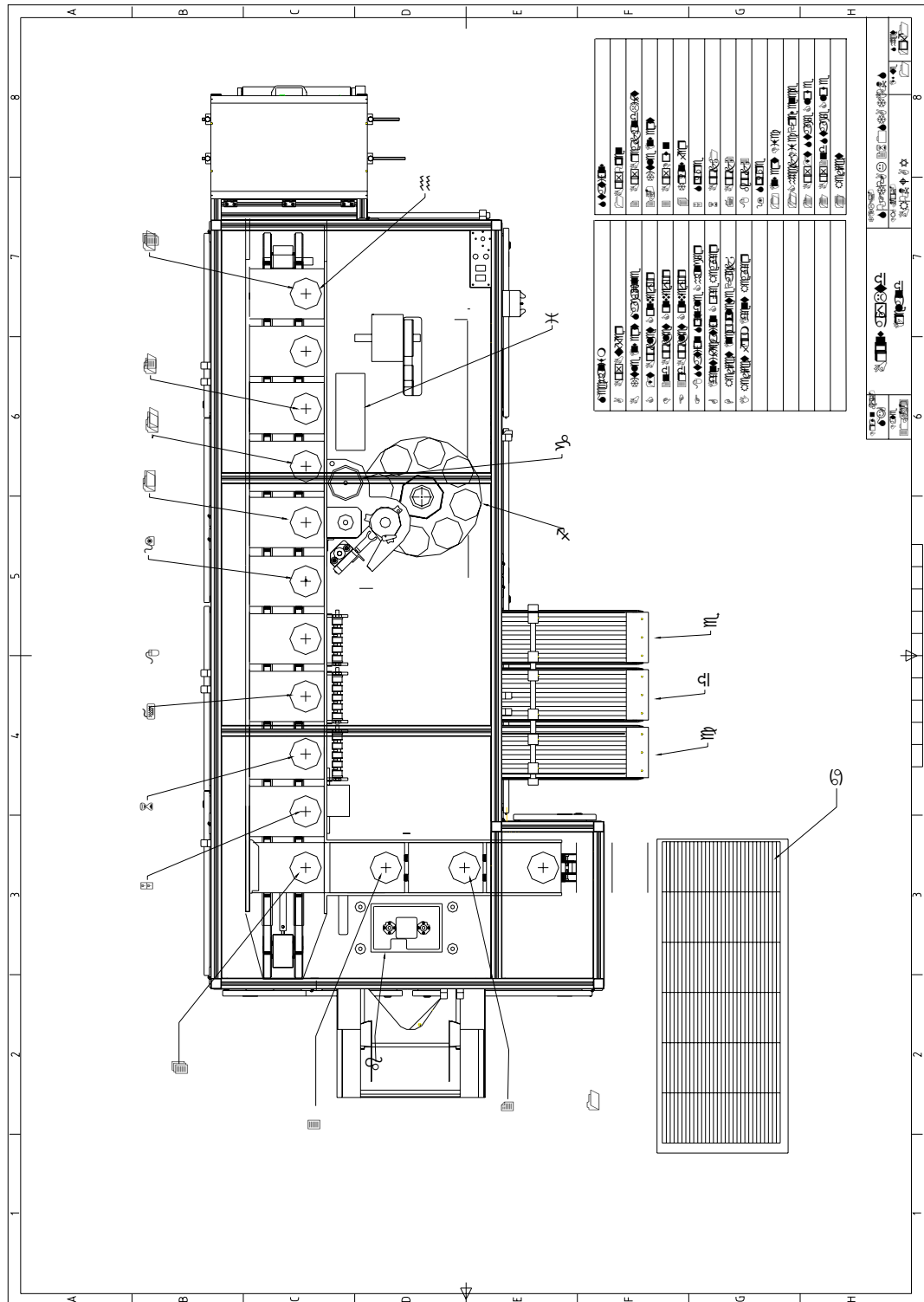

Machine Specification

Machine Speed	60 cycles per minute depending on box quality and type.
Air Pressure	6 Bar
Machine Dimensions	2.96m long x 1.87m wide
Machine Weight	2000kg
Colour	RAL 7035
Power Requirements	4KW/208-220V/50-60Hz
Box Feeder Capacity	300 boxes (600 optionally)
Title Sheet Insertion capacity	1800 sheets @ 0.15mm thick
Booklet Conveyor #1	1.1m long x 180mm wide accumulating up to 3800, 2-page booklets
Booklet Conveyor #2	1.1m long x 180mm wide (adjustable down to 120mm) accumulating up to 7600 single page booklets.
Booklet Conveyor #3	1.1m long x 180mm wide (adjustable down to 120mm) accumulating up to 7600 single page booklets.
Disc Spindle Change	8 spindles (175 discs/spindle)
CE Approved	
Magazine Capacities.	
Box Feeder:	100 to 300 box feeders available
Title insert capacity:	1800 @ 0.15mm thick sheets.
Booklet Conveyors # 1,2 & 3:	1.1m long x 180mm wide (adjustable down to 120mm), accumulating up to 7600 single page booklets.
Disc Spindle Change:	8 spindles (up to 150 discs/spindle)

Bronway Ltd.

Bray Business Park
 Southern Cross Route
 Bray
 Co. Wicklow
 Ireland

Tel.: +353-1-2800200

Fax: +353-1-2845835

E-mail: info@bronway.com

Web: <http://www.bronway.com>